



CL30 LOADER

- Lifts and dumps standard 210 liter (10.6 ft³) carts at variable heights from 42"-120" (1.05-3.05 m).
- Loader dumps carts up to 300 kg (660 lbs) weight onto tables, into hoppers or other containers.
- Left- or right-hand versions.
- Chain lift mechanism
- Optimize the ergonomics of a production line.
- Adaptable to a wide variety of processing lines.
- Safe design prevents loaders from dropping carts.
- USDA accepted and CE approved. Built in conformity with AMI sanitary equipment design principles.



Loaders available with wheels for portability

CL30 LOADER

Danfotech loaders are available in a standard version or custom designed according to your specifications. The loaders are manufactured from stainless steel, resistant to the corrosive environments found in food processing plants. Sanitary design of unit provides easy access for effective cleaning of the equipment. Each loader is supplied with an operator panel, control box, and safety features.

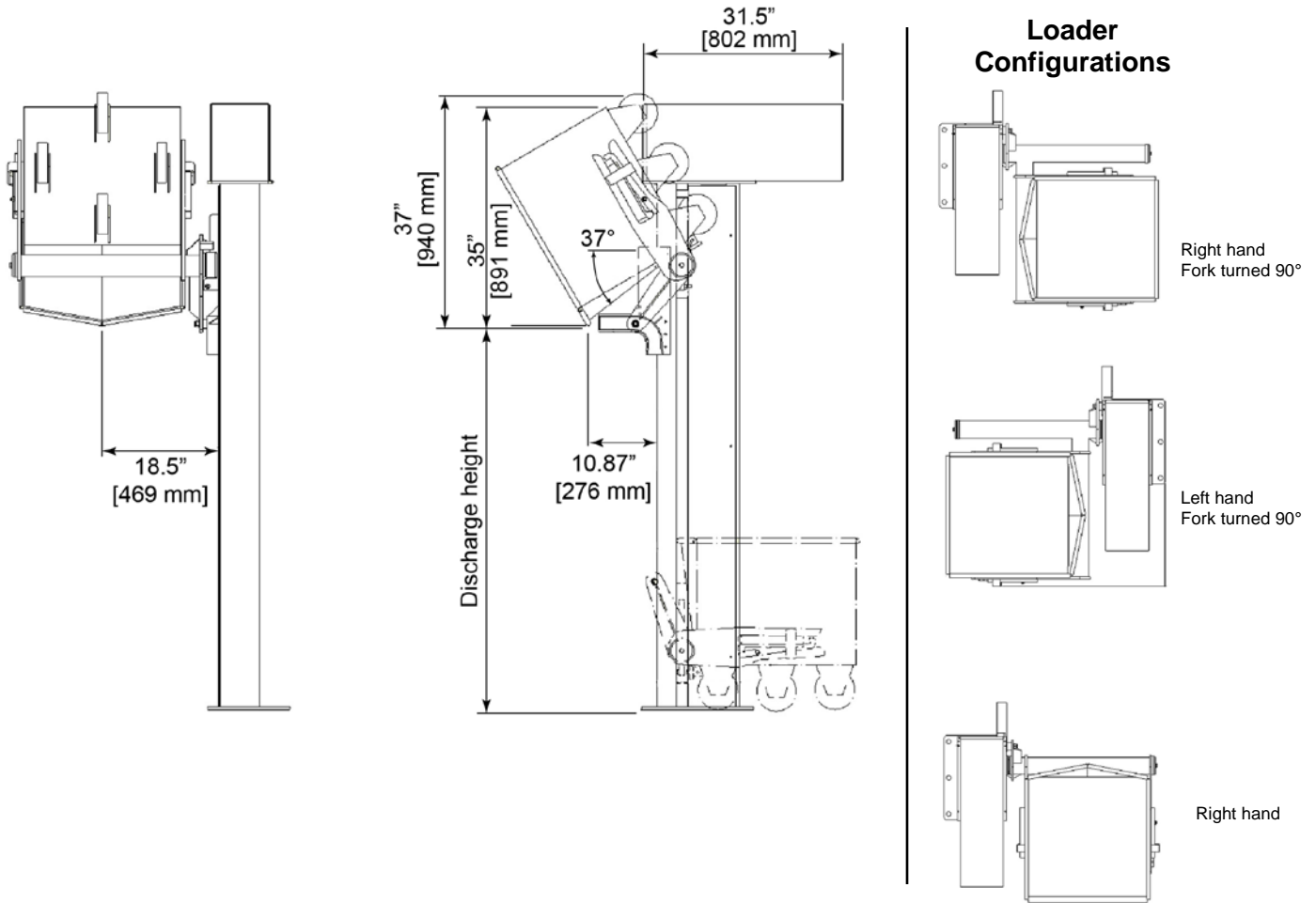

CL30 LOADERS			
Voltage	Motor	Control Voltage	Capacity
220/400/415 or 460 V, 3-phase	1 hp 0.75 kW	24 V AC or DC	660 lbs (300 kg)

01/18 E